NORTH LONDON WASTE AUTHORITY

NORTH LONDON HEAT AND POWER PROJECT

DCO SCHEDULES 6-8 EXPLANATORY DIAGRAMS

The Planning Act 2008 The Infrastructure
Planning (Applications: Prescribed
Forms and Procedure) Regulations 2009
Regulation 5 (2) (q)

AD03.05

Revision 1 |

August 2016

INTRODUCTION

This document has been prepared to support North London Waste Authority's (the Applicant's) application (the Application) for a Development Consent Order (DCO) made pursuant to the Planning Act 2008 (as amended).

This document, produced pursuant to Regulation 5 (2) (q) of the Applications: Prescribed Forms and Procedure Regulations 2009 (as amended) and Appendix 1 to the Planning Inspectorate Advice Note 6 (June, 2012) should be read alongside the other information that has been submitted with the Application, in accordance with the statutory requirements set out in Regulation 5, 6 and 7 of the Infrastructure Planning (Applications: Prescribed Forms and Procedure) Regulations 2009 (as amended).

This document provides explanatory diagrams to illustrate the sections of streets, footpaths, towpaths and cycleways to be temporarily suspended, temporarily stopped up or extinguished as identified in Schedule 6, 7, and 8 of the draft DCO (AD03.01).

Each schedule is repeated in this document in full with an accompanying diagram which identifies the area concerned and relevant plot numbers. As identified in the schedules the full details have been provided on submitted drawings C_0012 Rev 01, C_0013 Rev 00 and C_0014 Rev 01.

DRAFT DCO SCHEDULE 6 - PUBLIC RIGHT OF WAY TO BE TEMPORARILY SUSPENDED

LEGEND

Order Limits

Borough Boundary

Water

Plot Boundary

XX

Plot Number

Public Right of Way to be suspended

(1) Area	(2) Public right of way to be temporarily suspended	(3) Extent of temporary suspension	(4) Temporary new public right of way to be provided in substitution	Diagram 1
In the London Borough of Enfield.	The section of pavement on the north side of Advent Way within plots 30 and 31, as shown on the land plans, plan C_0013 Rev 00, and in more detail on diagram 1 on page 2 of the DCO schedules 6-8 explanatory diagrams.	For approximately 41 metres on Advent Way and into the southern entrance to the Edmonton EcoPark.	Approximately 42 metres of temporary footpath in the area shown cross hatched at the southern exit entrance to the Edmonton EcoPark leading onto Advent Way as shown on plan C_0013 Rev 00.	

LEGEND	
—	Order Limits
- - -	Borough Boundary
■	Water
—	Plot Boundary
XX	Plot Number
■	Public Right of Way to be suspended

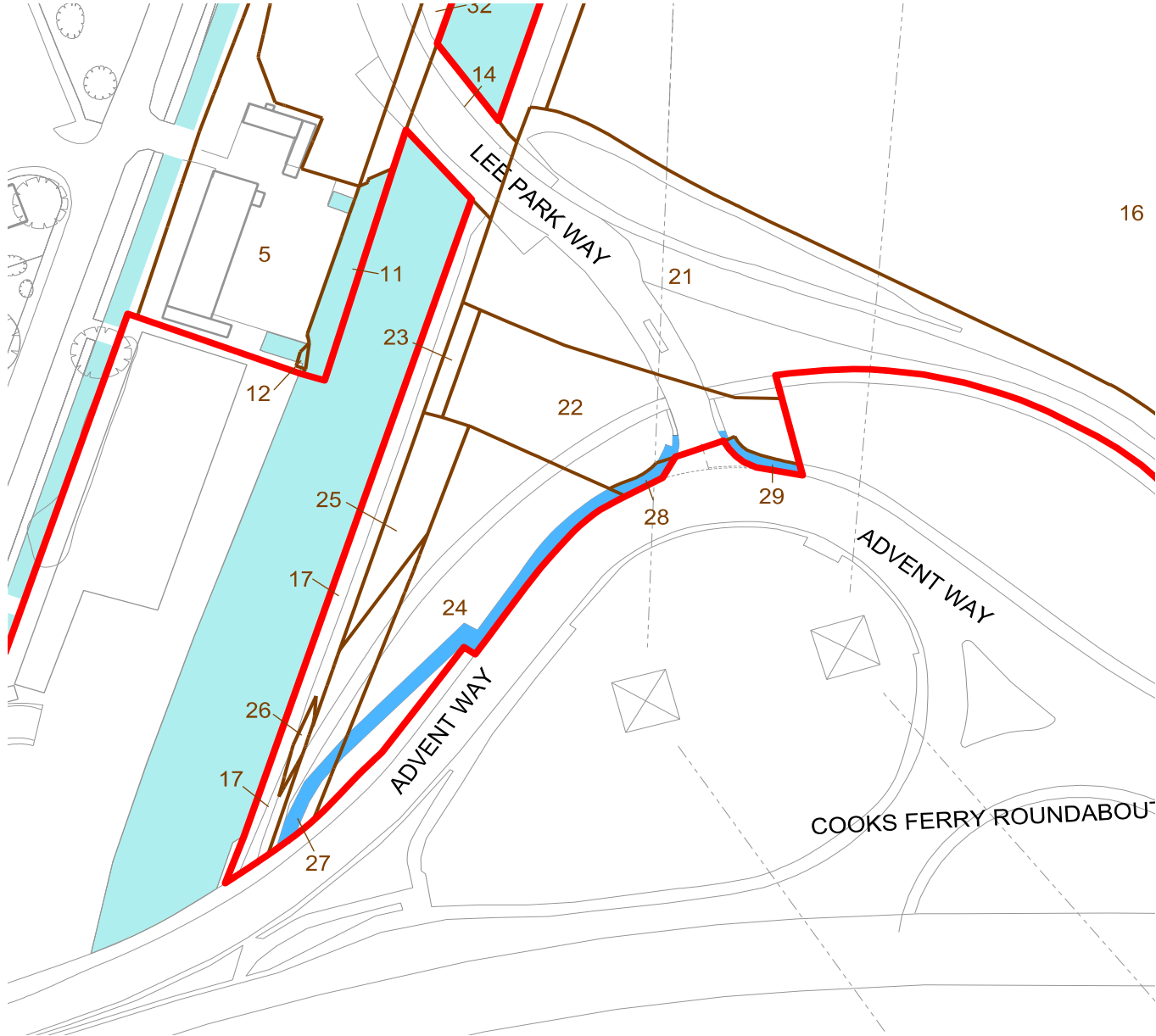
(1) Area	(2) Public right of way to be temporarily suspended	(3) Extent of temporary suspension	(4) Temporary new public right of way to be provided in substitution	Diagram 2
In the London Borough of Enfield.	The section of footpath and pavement running parallel with Advent Way to after the junction of Advent Way with Lee Park Way within plots 22, 24, 27, 28 and 29, as shown on the land plans, plan C_0014 Rev 01 and in more detail on diagram 2 on page 3 of the DCO schedules 6-8 explanatory diagrams.	For approximately 130 metres within plots 27, 24, 28, 22 and 29 shown on the land plans and on plan C_0014 Rev 01.	Approximately 130 metres of temporary footpath in the area shown cross hatched bordering the northern edge of Advent Way and the southern section of Lee Park Way as shown on plan C_0014 Rev 01.	

LEGEND	
	Order Limits
	Borough Boundary
	Water
	Plot Boundary
XX	Plot Number
	Public Right of Way to be suspended
	Approximate measurement taken

(1) Area	(2) Public right of way to be temporarily suspended	(3) Extent of temporary suspension	(4) Temporary new public right of way to be provided in substitution	Diagram 3
In the London Borough of Enfield.	The section of footpath and cycle path running from the junction of Advent Way with Lee Park Way and along Lee Park Way within plots 14, 15, 21, 22 and 32, as shown on the land plans, plan C_0014 Rev 01 and in more detail on diagram 3 on page 4 of the DCO schedules 6-8 explanatory diagrams.	For approximately 315 metres within plots 14, 15, 21, 22 and 32 from the junction of Advent Way with Lee Park Way and along Lee Park Way.	Approximately 315 metres of temporary footpath and cycle path in the area shown cross hatched to the north of Advent Way and the east of the Edmonton EcoPark as shown on plan C_0014 Rev 01.	

LEGEND	
	Order Limits
	Borough Boundary
	Water
	Plot Boundary
	Plot Number
	Public Right of Way to be suspended

Diagram 4			
(1) Area	(2) Public right of way to be temporarily suspended	(3) Extent of temporary suspension	(4) Temporary new public right of way to be provided in substitution
In the London Borough of Enfield.	Footpath leading from Lee Park Way to the tow path on the River Lee Navigation within plot 21, as shown on the land plans, plan C_0014 Rev 01 and in more detail on diagram 4 on page 5 of the DCO schedules 6-8 explanatory diagrams.	For approximately 41 metres at the point of the access to be constructed to the temporary laydown area from Lee Park Way towards the eastern bank of the River Lee Navigation (north of the bridge over the River Lee Navigation).	Approximately 41 metres of temporary footpath in the area shown cross hatched to the north of Lee Park Way and the east of the River Lee Navigation on plan C_0014 Rev 01.

LEGEND	
—	Order Limits
- - -	Borough Boundary
■	Water
—	Plot Boundary
XX	Plot Number
■	Public Right of Way to be suspended

Diagram 5			
(1) Area	(2) Public right of way to be temporarily suspended	(3) Extent of temporary suspension	(4) Temporary new public right of way to be provided in substitution
In the London Borough of Enfield.	Towpath, footpath and cycle path on the eastern bank of the River Lee Navigation within plots 13 and 17, as shown on the land plans, plan C_0014 Rev 01 and in more detail on diagram 5 on page 6 of the DCO schedules 6-8 explanatory diagrams.	For approximately 26 metres under the bridge over the River Lee Navigation forming part of Lee Park Way.	Approximately 201 metres of temporary footpath in the area shown on plan C_0014 Rev 01.



LEGEND

—	Order Limits		Public Right of Way to be suspended
- - -	Borough Boundary	↔	Approximate measurement taken
	Water		
—	Plot Boundary		
XX	Plot Number		

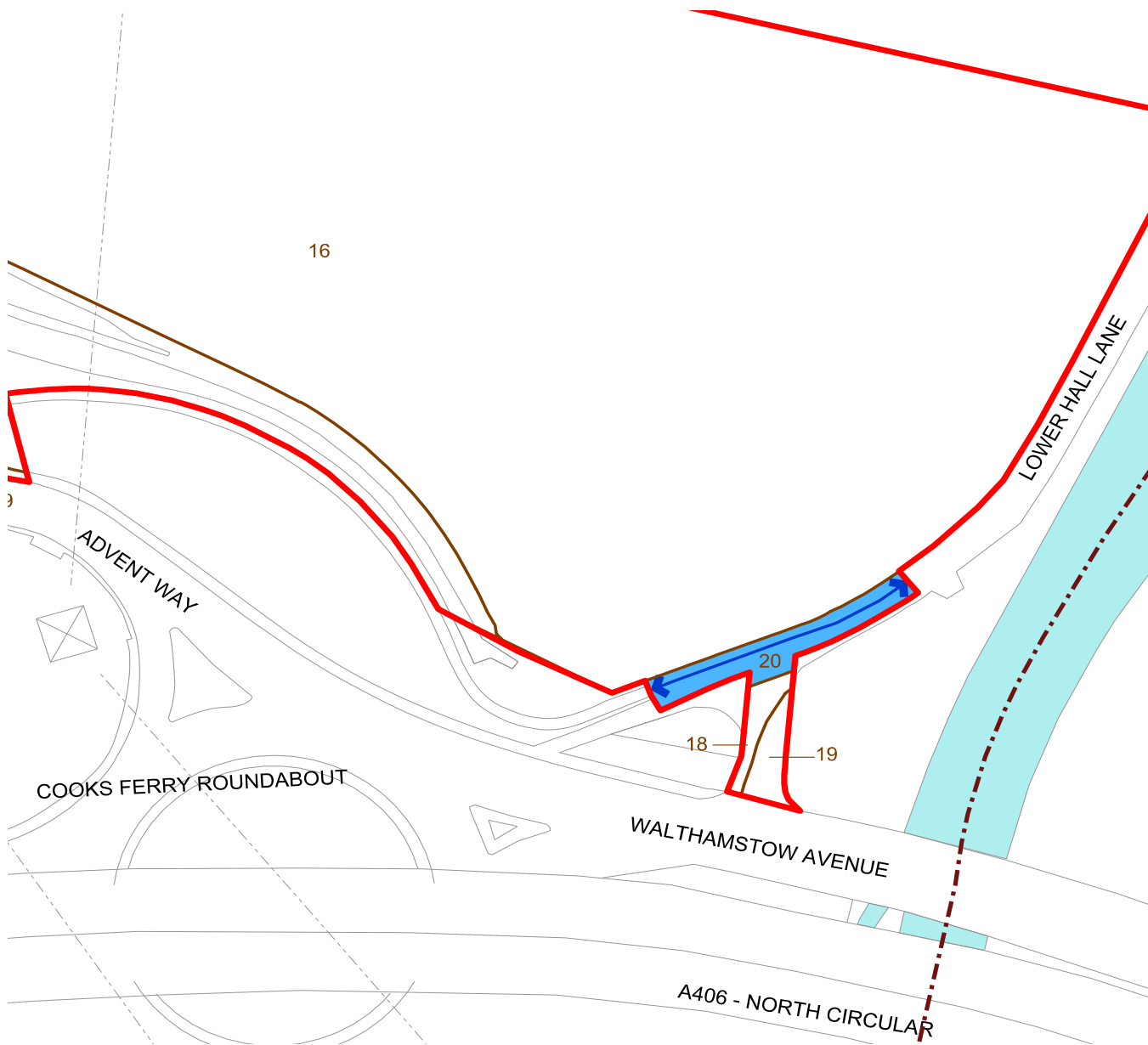
(1) Area	(2) Public right of way to be temporarily suspended	(3) Extent of temporary suspension	(4) Temporary new public right of way to be provided in substitution	Diagram 6
In the London Borough of Enfield.	Cycle path on Lower Hall Lane within plot 20, as shown on the land plans, C_0014 Rev 01 and in more detail on diagram 6 on page 7 of the DCO schedules 6-8 explanatory diagrams.	For approximately 59 metres across the part of Lower Hall Lane bordering the access from Lower Hall Lane to the temporary laydown area.	Approximately 59 metres of temporary footpath in the area shown cross hatched across Lower Hall Lane leading to the junction with Walthamstow Avenue on plan C_0014 Rev 01.	

LEGEND	
	Order Limits
	Borough Boundary
	Water
	Plot Boundary
	Plot Number
	Public Right of Way to be suspended

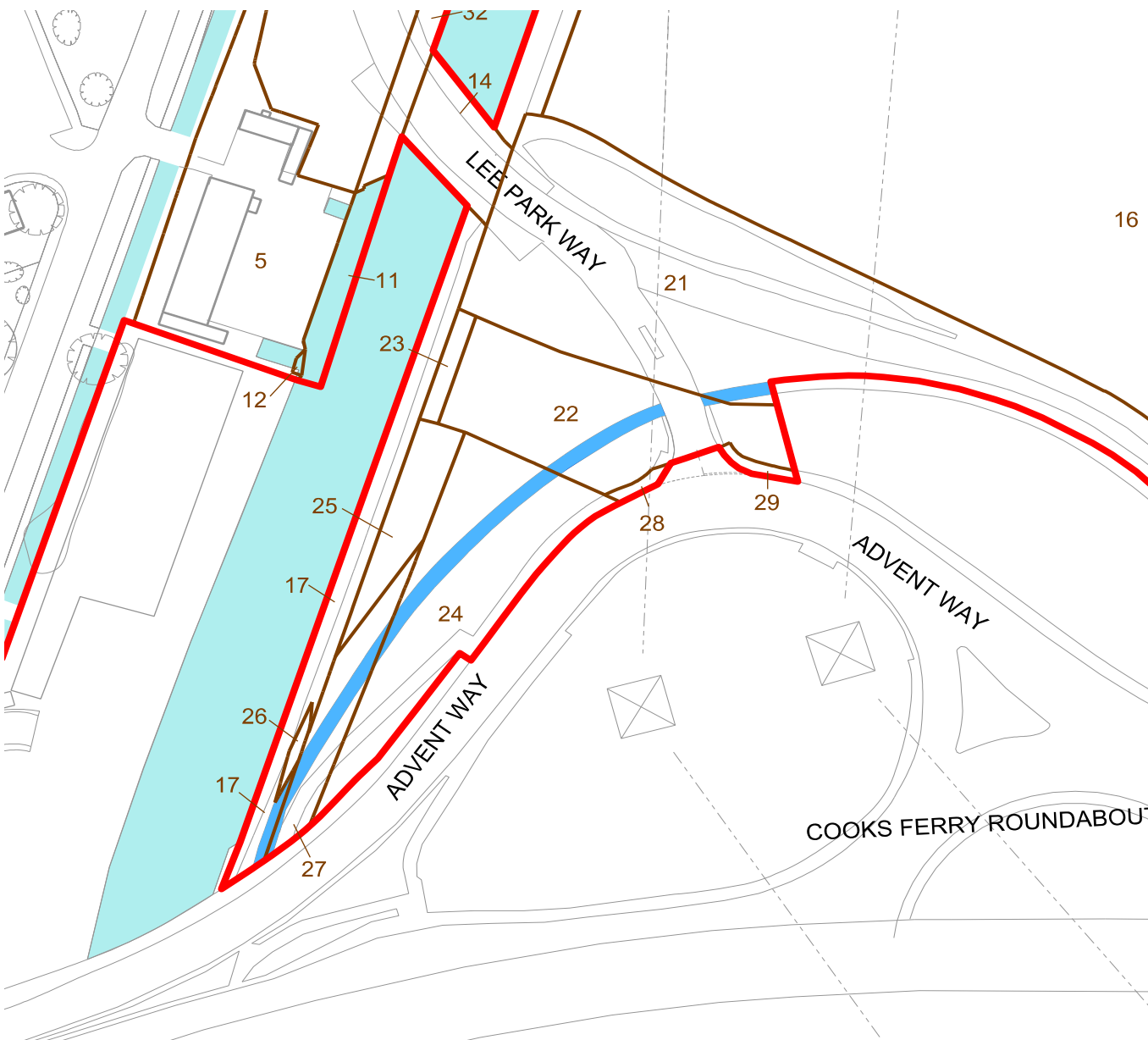
(1) Area	(2) Public right of way to be temporarily suspended	(3) Extent of temporary suspension	(4) Temporary new public right of way to be provided in substitution	Diagram 7
In the London Borough of Enfield.	Cycle path running parallel with Advent Way to after the junction of Advent Way with Lee Park Way, within plots 17, 27, 24, 22 and 21, as shown on the land plans, plan C_0014 Rev 01 and in more detail on diagram 7 on page 8 of the DCO schedules 6-8 explanatory diagrams.	For approximately 131 metres across plots 17, 27, 24, 22, 21 on the land plans, running to the north of Advent Way, east of the tow path running along the western edge of the River Lee Navigation, cutting across Lee Park Way and towards Lower Hall Lane.	Approximately 131 metres of temporary footpath in the area shown cross hatched across plots 17, 27, 24, 22, 21 on the land plans on the land to the east of the River Lee Navigation and north of Advent Way, as shown on plan C_0014 Rev 01	

DRAFT DCO SCHEDULE 7 - PUBLIC RIGHT OF WAY TO BE EXTINGUISHED

LEGEND

Order Limits

Borough Boundary

Water

Plot Boundary

XX

Plot Number

Public Right of Way to be extinguished

Approximate measurement taken

(1) Area	(2) Public right of way to be extinguished	(3) Extent of public right of way to be extinguished	(4) New public right of way to be substituted	Diagram 8
In the London Borough of Enfield.	The section of footpath and cycle path on Lee Park Way within plots 14, 15, 21, 22 and 32, as shown on the land plans and in more detail on diagram 8 on page 9 of the DCO schedules 6-8 explanatory diagrams.	For approximately 315 metres from the junction of Advent Way and Lee Park Way leading north as shown hatched red on plan C_0014 Rev 01 on Lee Park Way.	Approximately 315 metres of footpath along Lee Park Way and approximately 314.5 metres of cycle path along Lee Park Way within plots 14, 15, 21, 22 and 32 on the land plans and as shown on plan C_0014 Rev 01.	

DRAFT DCO SCHEDULE 8 - STREETS TO BE TEMPORARILY STOPPED UP

LEGEND

Order Limits

Borough Boundary

Water

Plot Boundary

XX

Plot Number

Streets to be temporarily stopped up

Approximate measurement taken

(1) Area	(2) Street to be temporarily stopped up	(3) Extent of temporary stopping up	Diagram 9
In the London Borough of Enfield.	Advent Way, within plot 31, as shown on the land plans and on plan C_0013 Rev 00.	For approximately 42 metres at the entrance to the south of the Edmonton EcoPark within plot 31, as shown on the land plans, plan C_0013 Rev 00 and in more detail on diagram 9 on page 10 of the DCO schedules 6-8 explanatory diagrams.	

LEGEND

- Order Limits
- Borough Boundary
- Water
- Plot Boundary
- Plot Number
- Streets to be temporarily stopped up
- Approximate measurement taken

Diagram 10



LEGEND

Order Limits

Borough Boundary

Water

Plot Boundary

XX

Plot Number

Streets to be temporarily stopped up

Approximate measurement taken

(1) Area	(2) Street to be temporarily stopped up	(3) Extent of temporary stopping up	Diagram 11
In the London Borough of Enfield.	Lower Hall Lane, within plots 18, 19 and 20, as shown on the land plans and on plan C_0014 Rev 01.	For approximately 41 metres from the junction of Lower Hall Lane and Walthamstow Avenue to the entrance to the temporary laydown area from Lower Hall Lane, within plots 18, 19 and 20, as shown on the land plans, plan C_0014 Rev 01 and in more detail on diagram 11 on page 12 of the DCO schedules 6-8 explanatory diagrams.	

LEGEND

- Order Limits
- Borough Boundary
- Water
- Plot Boundary
- Plot Number
- Streets to be temporarily stopped up
- Approximate measurement taken

Diagram 12



LEGEND

- Order Limits
- Borough Boundary
- Water
- Plot Boundary
- Plot Number
- Streets to be temporarily stopped up

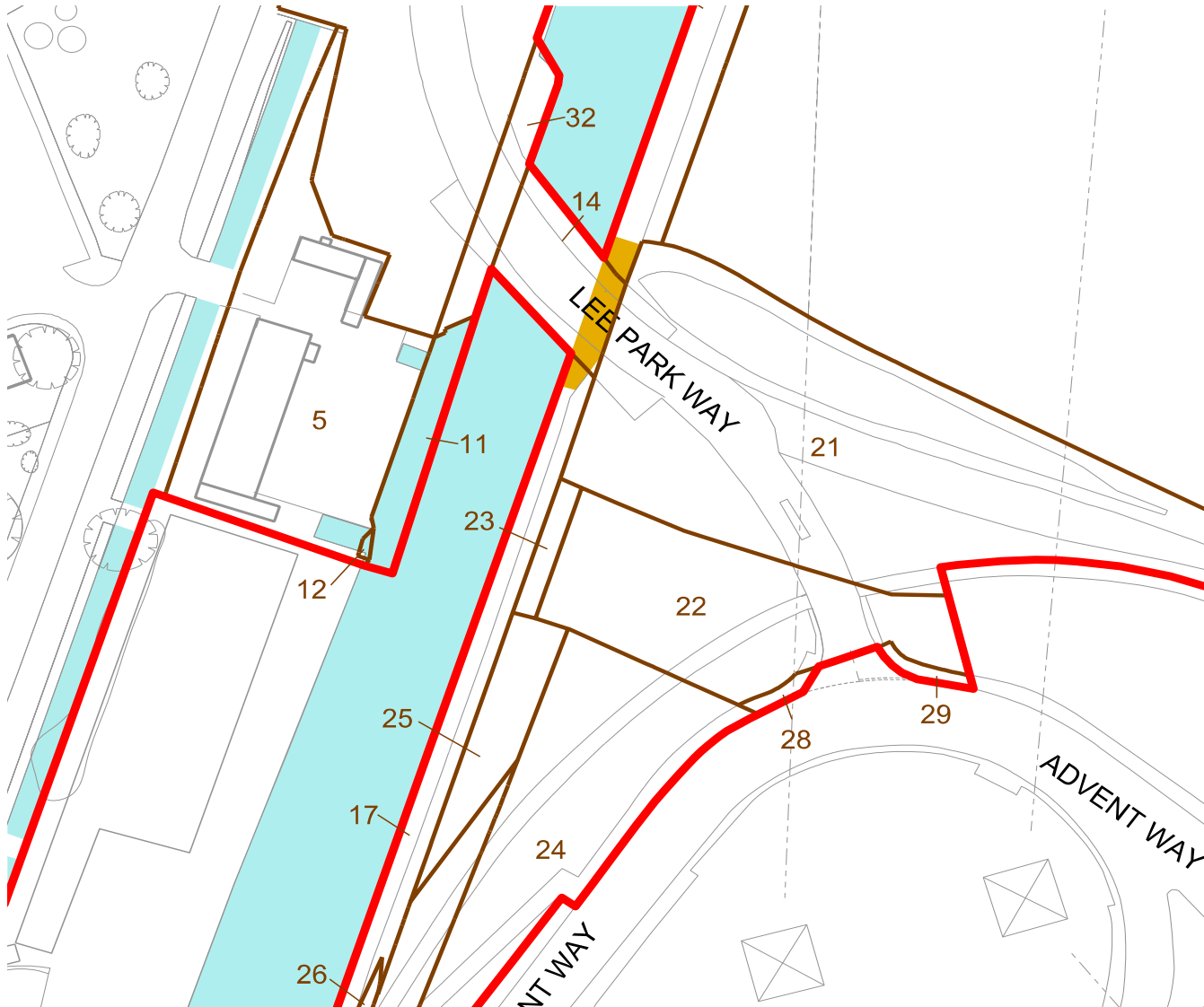
(1) Area	(2) Street to be temporarily stopped up	(3) Extent of temporary stopping up	Diagram 13
In the London Borough of Enfield.	Tow path, footpath and cycle path along the eastern side of the River Lee Navigation within plots 13 and 17, as shown on the land plans and on plan C_0014 Rev 01.	For approximately 26 metres within plots 13 and 17 from Advent Way, running north along the eastern bank of the River Lee Navigation towards the northern end of the temporary laydown area, as shown on the land plans, plan C_0014 Rev 01 and in more detail on diagram 13 on page 14 of the DCO schedules 6-8 explanatory diagrams.	

LEGEND

- Order Limits
- Borough Boundary
- Water
- Plot Boundary
- Plot Number
- Streets to be temporarily stopped up

Diagram 14

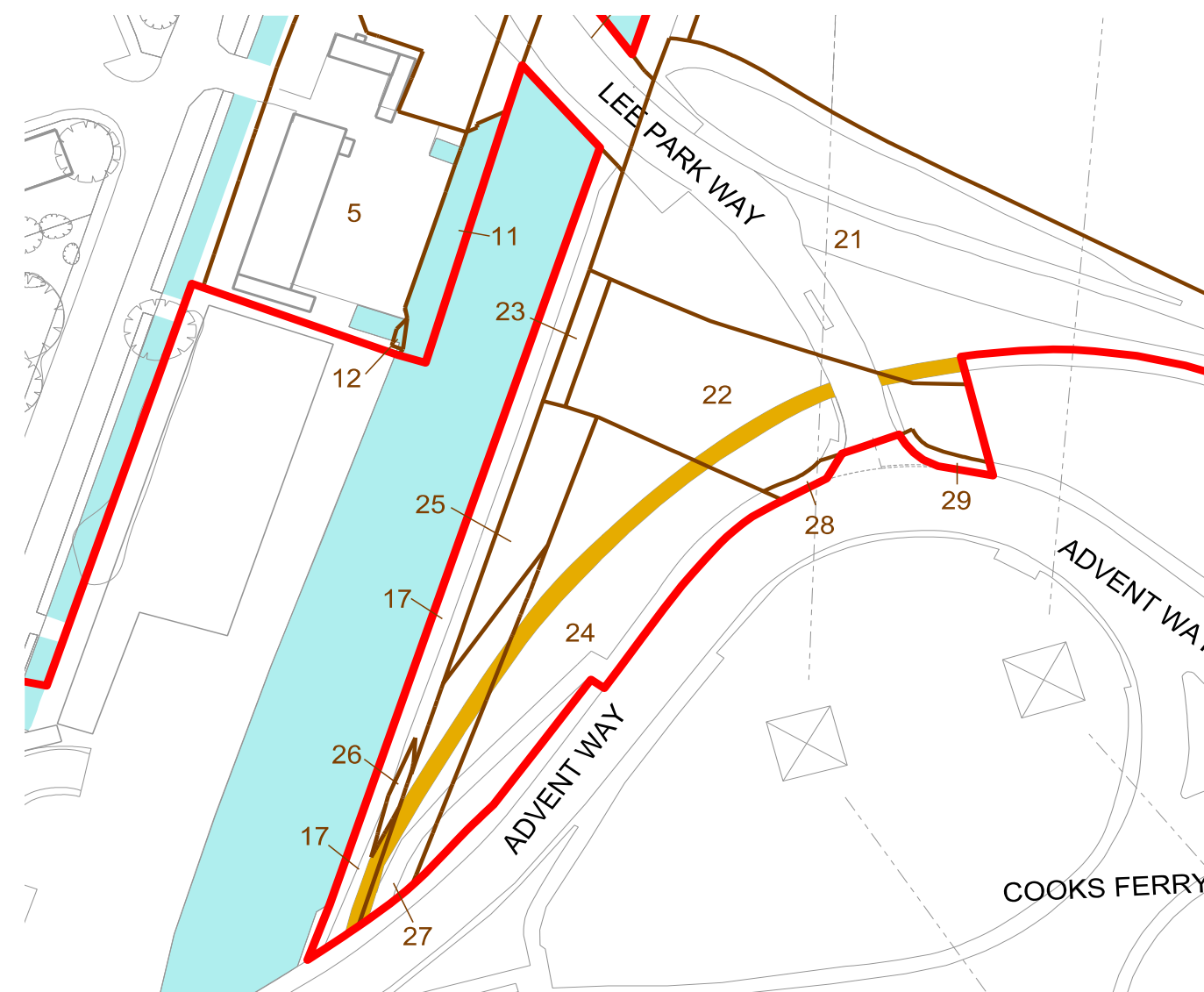

In the London Borough of Enfield.

Cycle path running parallel with Advent Way to the junction of Advent Way with Lee Park Way within plots 17, 27, 24, 22, 21, as shown on the land plans and on plan C_0014 Rev 01.

For approximately 131 metres within plots 17, 21, 22, 24 and 27, as shown on the land plans, plan C_0014 Rev 01 and in more detail on diagram 14 on page 15 of the DCO schedules 6-8 explanatory diagrams.

LEGEND

—	Order Limits		Streets to be temporarily stopped up
- - -	Borough Boundary	↔	Approximate measurement taken
	Water		
—	Plot Boundary		
XX	Plot Number		

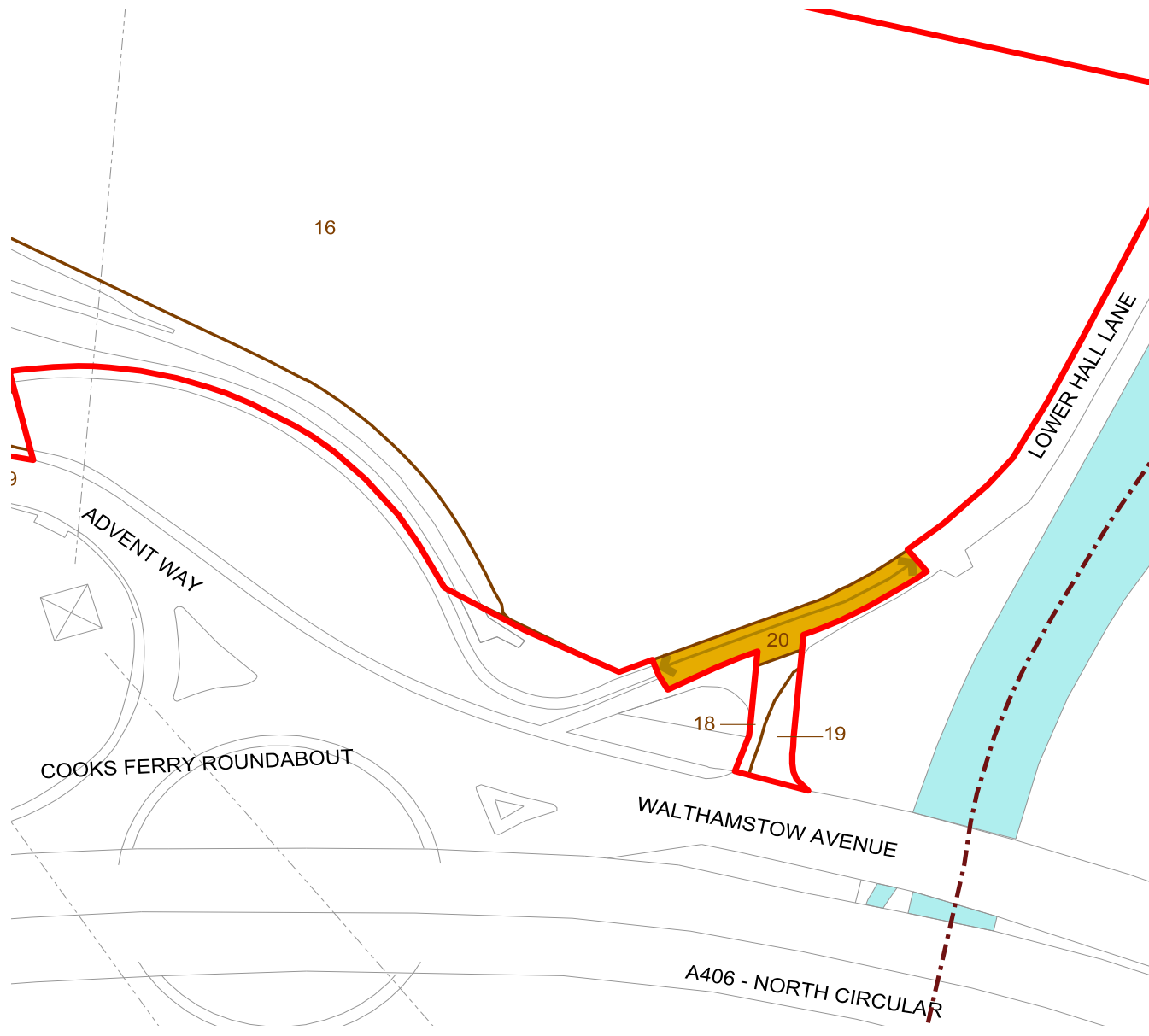
(1) Area	(2) Street to be temporarily stopped up	(3) Extent of temporary stopping up	Diagram 15
In the London Borough of Enfield.	Cycle path on Lower Hall Lane within plot 20, as shown on the land plans and on plan C_0014 Rev 01.	For approximately 59 metres across the part of Lower Hall Lane bordering the access from Lower Hall Lane to the temporary laydown area, within plot 20, as shown on the land plans, plan C_0014 Rev 01 and in more detail on diagram 15 on page 16 of the DCO schedules 6-8 explanatory diagrams.	

LEGEND

- Order Limits
- Borough Boundary
- Water
- Plot Boundary
- Plot Number
- Streets to be temporarily stopped up

Diagram 16

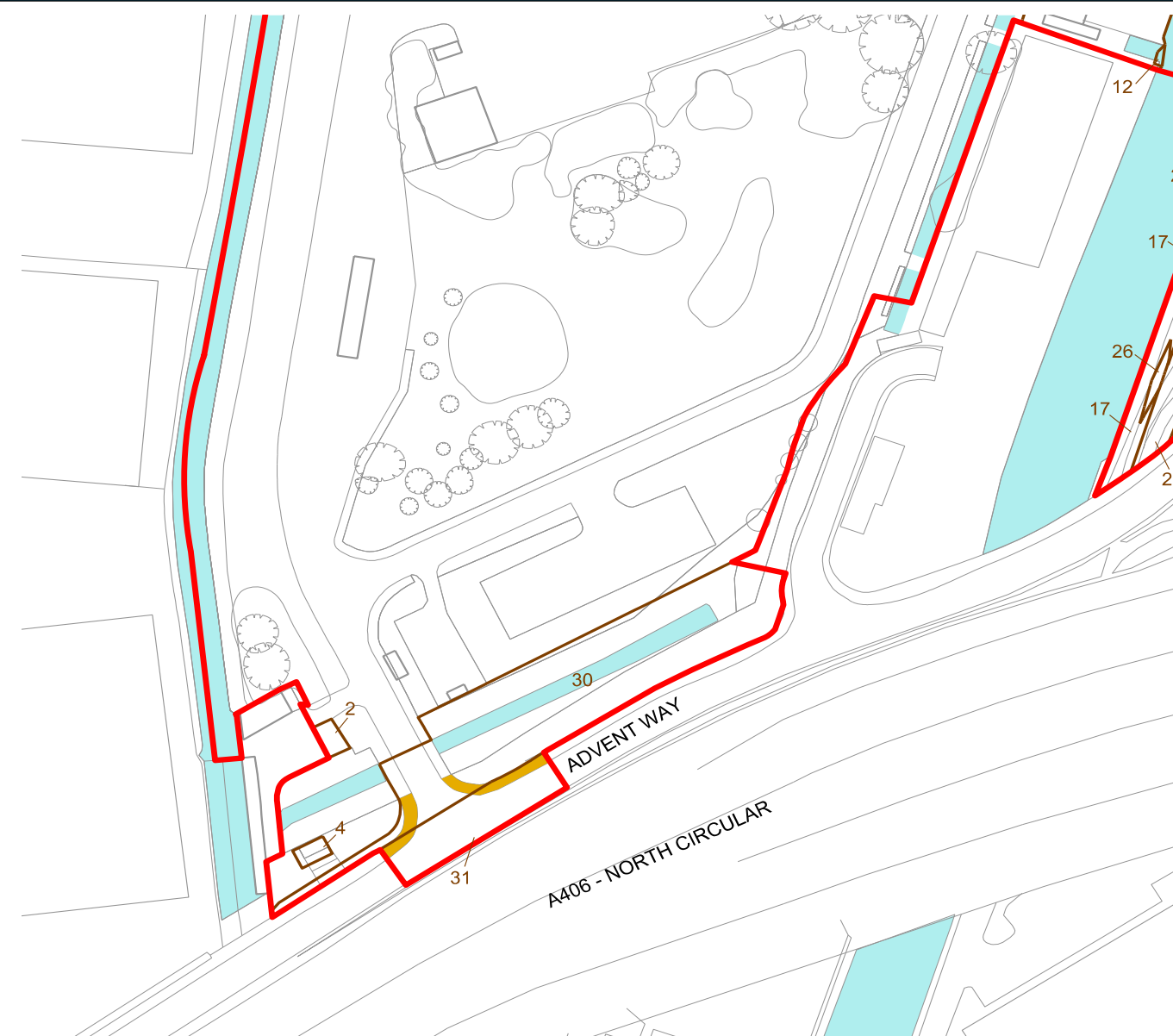

In the London Borough of Enfield.

The section of pavement on the north side of Advent Way, within plots 30 and 31, as shown on the land plans and on plan C_0013 Rev 00.

For approximately 41 metres on Advent Way and into the southern entrance to the Edmonton EcoPark, within plots 30 and 31, as shown on the land plans, plan C_0013 Rev 00 and in more detail on diagram 16 on page 17 of the DCO schedules 6-8 explanatory diagrams.

LEGEND

- Order Limits
- Borough Boundary
- Water
- Plot Boundary
- Plot Number
- Streets to be temporarily stopped up

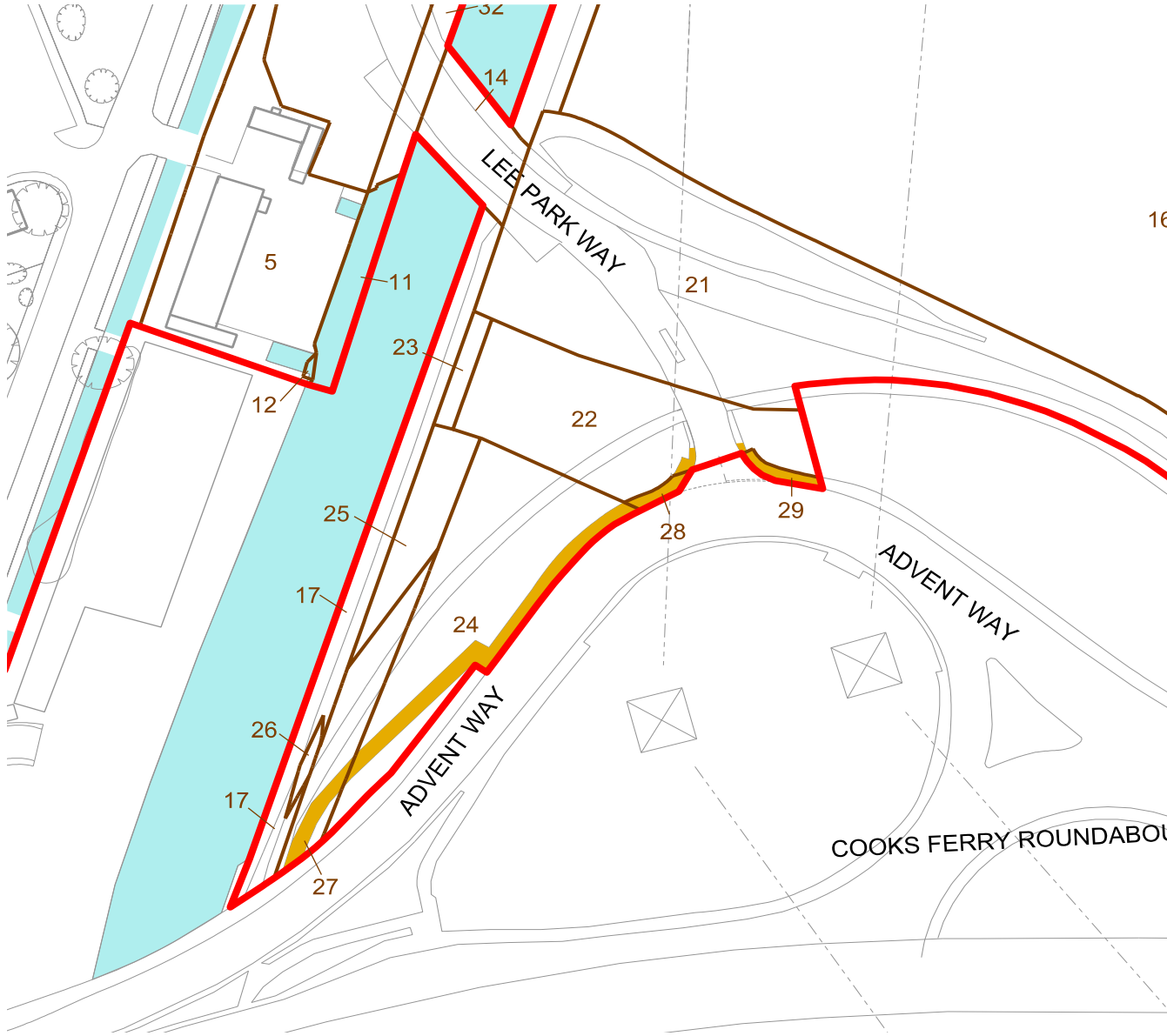
(1) Area	(2) Street to be temporarily stopped up	(3) Extent of temporary stopping up	Diagram 17
In the London Borough of Enfield.	The section of footpath and pavement running parallel with Advent Way to the junction of Advent Way with Lee Park Way within plots 22, 24, 27, 28 and 29, as shown on the land plans and plan C_0014 Rev 01.	For approximately 130 metres within plots 27, 24, 28, 22 and 29, as shown on the land plans, plan C_0014 Rev 01 and in more detail on diagram 17 on page 18 of the DCO schedules 6-8 explanatory diagrams.	

LEGEND

- Order Limits
- Borough Boundary
- Water
- Plot Boundary
- Plot Number
- Streets to be temporarily stopped up

Diagram 18

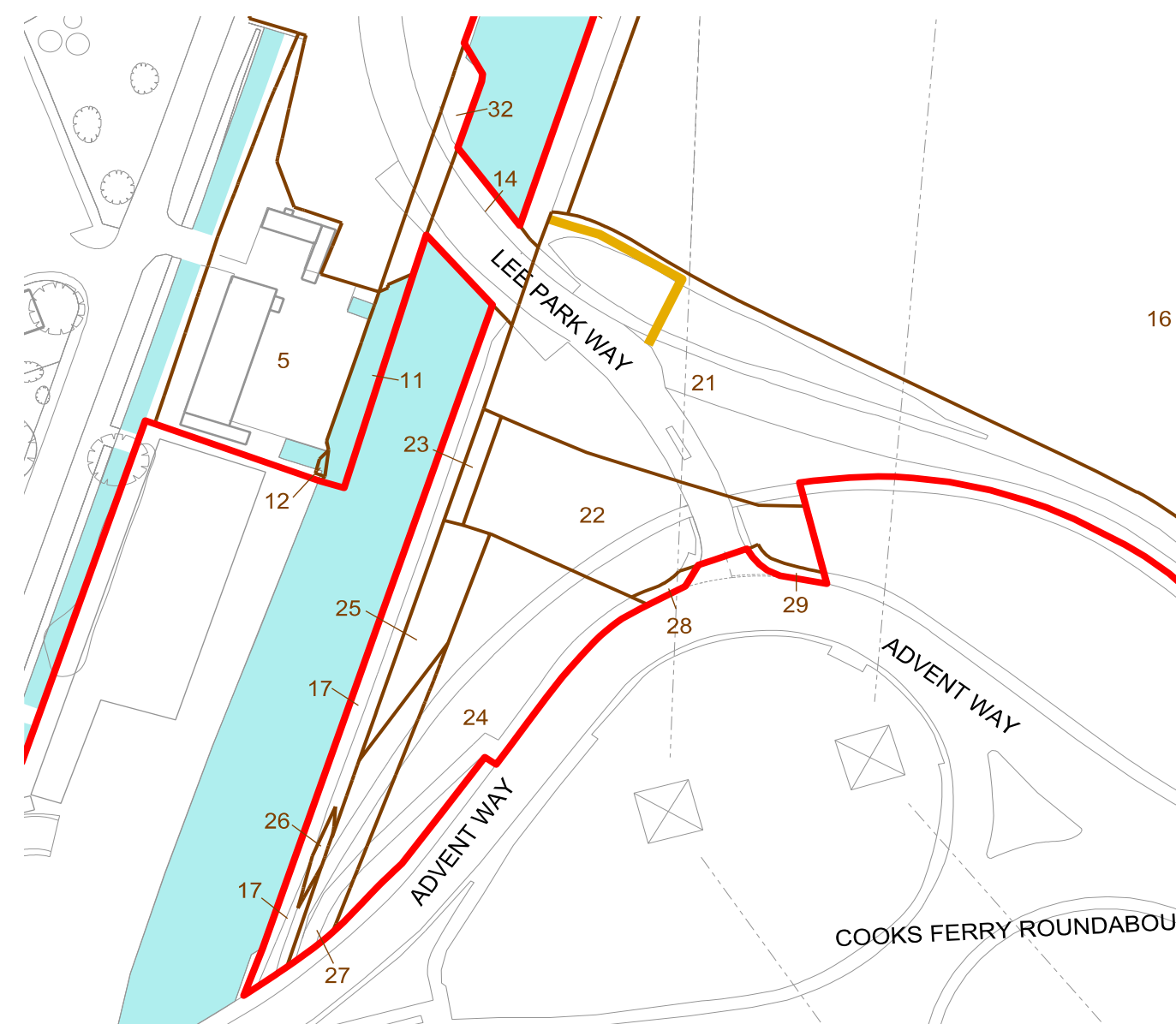

In the London Borough of Enfield.

Footpath leading from Lee Park Way to the tow path on the River Lee Navigation within plot 21, as shown on the land plans and on plan C_0014 Rev 01.

For approximately 37 metres from the point of the access to be constructed to the temporary laydown area from Lee Park Way towards the eastern bank of the River Lee Navigation (north of the bridge over the River Lee Navigation), within plot 21, as show on the land plans, plan C-0014 Rev 01 and in more detail on diagram 18 on page 19 of the DCO schedules 6-8 explanatory diagrams.



Series 03 Draft Development
Consent Order

**NORTH LONDON WASTE
AUTHORITY**

1b Berol House, 25 Ashley Road
Tottenham Hale
N17 9LJ

Telephone: 020 8489 5730
Fax: 020 8365 0254
Email: project@northlondonheatandpower.london